

Lifestyle Homes

of Southwest Oklahoma

Pete and Patti Rhea

Luxury Home Builders

Building Homes in Southwest Oklahoma since 1992

prhea@onlineok.com

28 NW Lakewood Drive

Lawton, OK 73505

580-591-2412

19 Lakewood

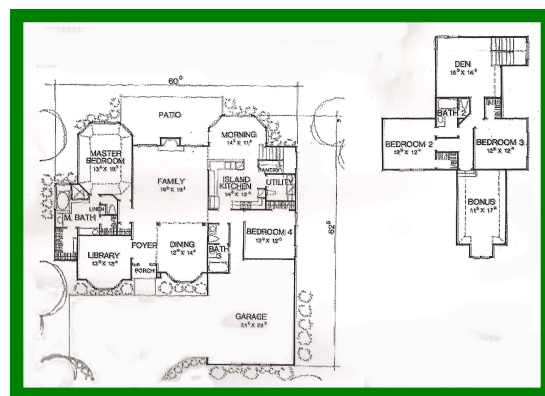

Features:

- Approximately 3400 square feet
- Four bedrooms, 2 1/2 baths, 3 car garage
- Study, formal dining, and living room downstairs; family room and flex room upstairs
- Covered patio
- Granite countertops in kitchen
- Lake front lot with beautiful view of mountains
- Large lot (over 1/2 acre)

Estimated completion date is December 15, 2008. **Directions:** From Lawton, go west on Old Cache Road. After passing Naturescape and crossing a small bridge, turn north into Shelter Lakes. Bear left at the intersection onto Lakewood. 19 Lakewood is on the corner where the street turns sharply right..