

Lifestyle Homes

of Southwest Oklahoma

Pete and Patti Rhea

Luxury Home Builders

Building Homes in Southwest Oklahoma since 1992

prhea@onlineok.com

2 NW Briarcreek Drive

Lawton, OK 73505

580-591-2412

2 Lakewood Drive

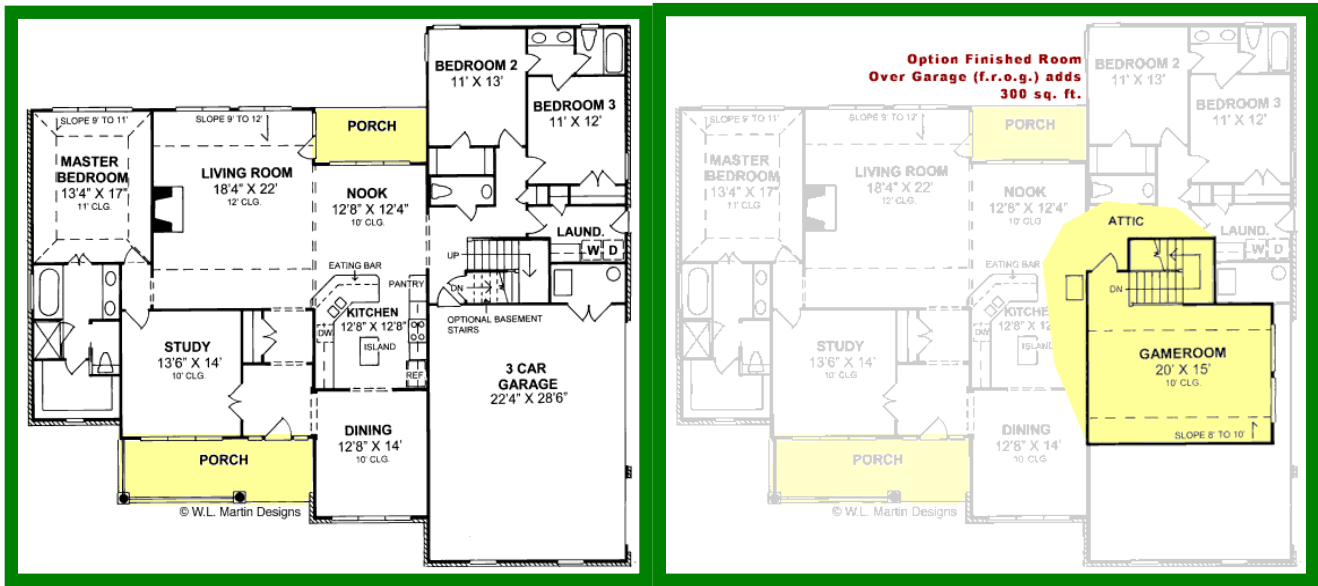

Features:

Approximately 3300 square feet

Four or Five bedrooms, 3 1/2 baths, 3 car garage

Not pictured: additional bedroom on second floor, bathroom on second floor, and large closet added to game room

Study, formal dining, and great room downstairs; game room (or bedroom) upstairs

Lots of ceramic tile, granite countertops in kitchen Wood floors in dining room and study Large lot (over 1/2 acre)

Directions: From Lawton, go west on Old Cache Road. After passing Lawton Christian School, Naturescape, and a small bridge turn north into Shelter Lakes. 2 Lakewood is at the intersection of Shelter Lakes Drive and Lakewood.